

INSTRUCTIONS FOR SERVICE KIT #100440

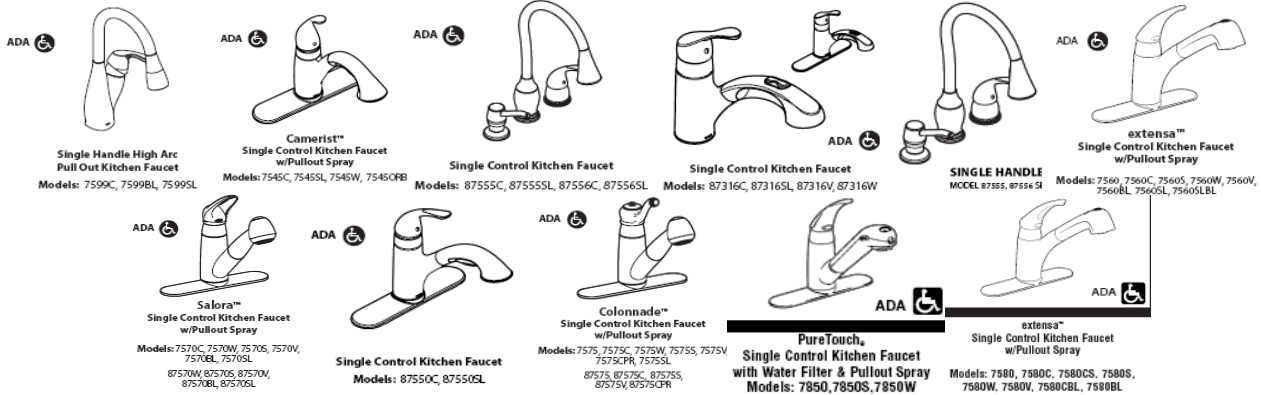

PARTS

INSTRUCTIONS

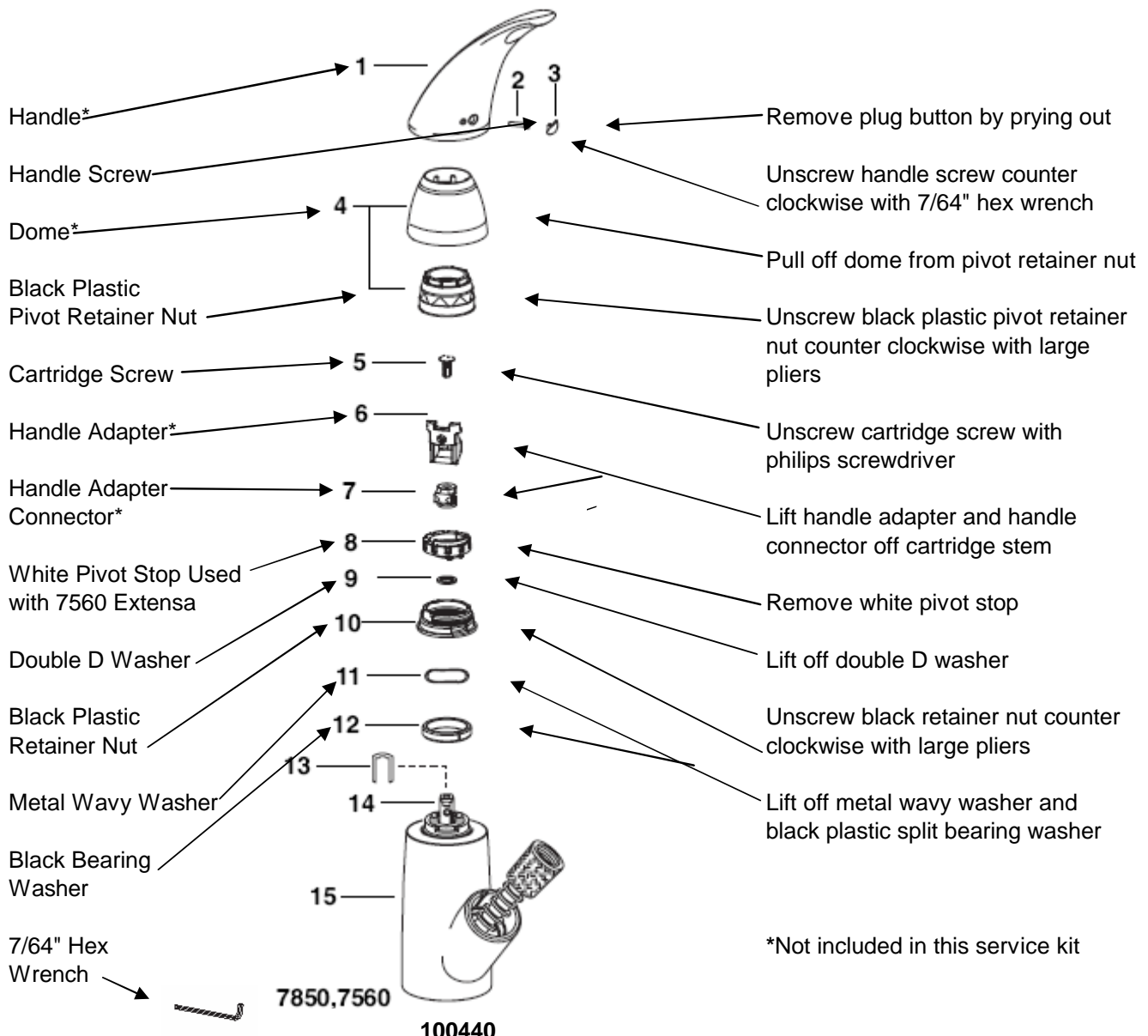

HELPFUL HINTS FOR SERVICE KITS #100440, 93980 AND 100429

- Remove Dome From Pivot Retainer Nut before removal or replacement

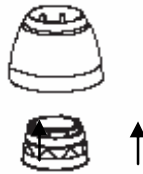

- To prevent cross threading, rotate all plastic parts in reverse (counter clockwise) to feel a "click" before tightening (clockwise)



- Position Pivot Stop with tallest side towards front of faucet facing up



- Position Handle Adapter with tallest side towards the front of faucet, tilt the top back when attaching dome and handle

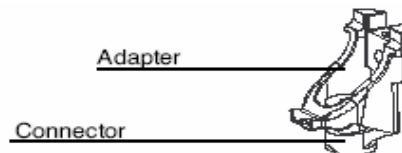

- If the hex opening of the Handle Screw becomes stripped, a T-15 Torx can be used to remove the screw



- To insure that the hot is on the left and the cold is on the right, position the stem of the cartridge with the notch and the vent hole facing forward and the numbers facing rear

